

# HIGH SPEED SMALL HOLE DRILLING EDM

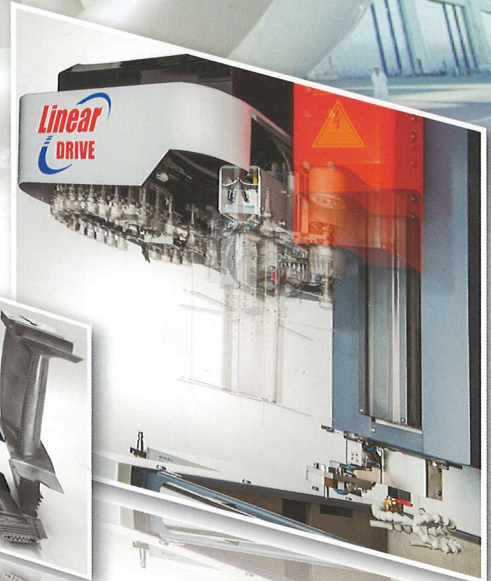

## FEATURES AD Series

### Compact Design

Single platform design for small footprint enclosed in 1900 x 2100mm space (75"x83").

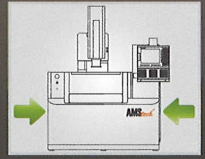

### Inverter High Pressure Water

Inverter controlled high pressure pump to increase flush pressure as the hole goes deeper. Ensures constant flush pressure and improve chip removed.



### Linear Motor Drive

Linear motor drives X and Y, with Precision Glass Scales, provide closed loop feedback for precision location and rapid electrode changing.

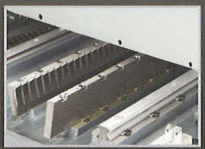

### Submerged Machining

Submerged cutting allows for better electrode entry and breakthrough and improves total cutting time. Submergible AB indexers are available from many suppliers. All 6 axes are controlled by the AMS Tech Cnc controller and program can be input by MDI, USB, RS232 and Ethernet.

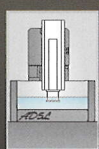

### Inverter Spindle Speed Control

Inverter controlled spindle improves the accuracy, reduces electrode wear, and helps to prevent back strikes after breakthrough.



### Canned Cycles & Programming

Various measuring cycles are available as well as canned cycles for various shapes.

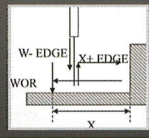





<b>SPECIFICATION</b>	<b>AD3L(F/S)</b>	<b>AD4L(F/S)</b>	<b>AD5L(F/S)</b>	<b>AD6L(F/S)</b>
Work table spec. (mm / inch)	500x300(19.7x11.8)	550x430 (21.6x16.9)	720x430 (28.3x16.9)	720x500 (28.3x19.7)
X,Y axis travel (mm / inch)	300x200(11.8x7.9)	400x300 (15.8x11.8)	500x300 (19.7x11.8)	600x400 (23.6x15.7)
Max. job load size (WxDxH mm)	700x450x280 (27.6x17.7x11)	800x550x330 (31.5x21.6x13)	890x670x330 (35x26.4x13)	950x780x380 (37.4x30.7x14.5)
Max. job load weight (kgw / lb)	800 (1764)	900 (1980)	1000 (2205)	1200 (2646)
Z axis ram travel (mm / inch)	250 (9.8)	300 (11.8)	300 (11.8)	350 (13.8)
W axis travel (mm / inch)	500 (19.7)	500 (19.7)	500 (19.7)	500 (19.7)
Automatic Tool Changer	10 or 20	10 or 20	10 or 20	10 or 20
Automatic Guide Changer	5~20	5~20	5~20	5~20
Max. electrode (mm / inch)	Ø0.2~Ø3.0 (Ø0.008~Ø0.12)	Ø0.2~Ø3.0 (Ø0.008~Ø0.12)	Ø0.2~Ø3.0 (Ø0.008~Ø0.12)	Ø0.2~Ø3.0 (Ø0.008~Ø0.12)
Max. electrode length (mm / inch)	400 (15.7)	400 (15.7)	400 (15.7)	400 (15.7)
Distance from guide to table ▶ <b>Standard</b>	30~280 (1.2~11)	30~330 (1.2~13)	30~330 (1.2~13)	30~380 (1.2~15)
Distance from guide to table ▶ <b>For AB Axis Table (S)</b>	185~435 (7.3~17.1)	185~485 (7.2~19.1)	185~485 (7.2~19.1)	185~535 (7.2~21.1)
Dielectric capacity (L / Gallon)	90(23.8) / 450(119)	90(23.8) / 450(119)	110 (29) / 450(119)	110 (29) / 600(159)
Dielectric type	Pure Water	Pure Water	Pure Water	Pure Water
Floor layout (WxDxH mm)	1750x1750x2100 (68.9x68.9x82.7) 1925x2100x2100 (75.8x82.7x82.7)	1750x1830x2100 (68.9x72.0x82.7) 1925x2230x2300 (75.8x87.8x90.6)	1850x1930x2300 (72.8x76.0x90.6) 2045x2230x2300 (80.5x87.8x90.6)	2000x2050x2300 (78.7x80.7x90.6) 2200x2560x2300 (86.6x100.8x90.6)
Machine body net (kgw / lb)	2000(4409) / 2800(6173)	2300(5071) / 2900(6394)	3000(6614) / 3000(6614)	3200(7055) / 3200(7055)
No. of Axis Control	X, Y, Z, W axis			

Work Tank height = 350mm, Submerge level = 250mm (Standard) : Work Tank height = 500mm, Submerge level = 400mm (AB indexer)

## FLOOR LAYOUT

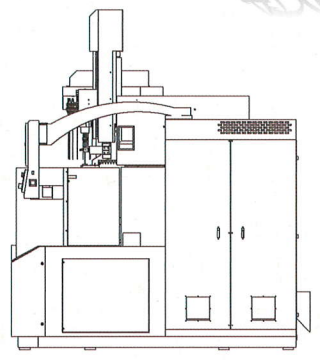
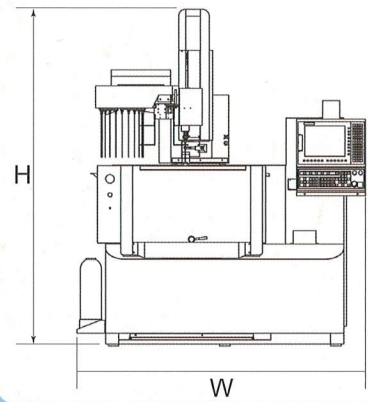
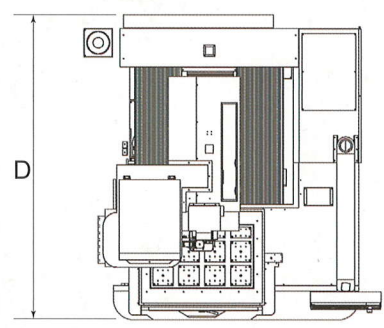

Unit:mm

## STANDARD ACCESSORIES

- Ceramic Guide  
0.5mm x1pcs ; 1.0 mm x1pcs
- Paper Filter  
5µm Fx1 pcs / Sx2 pcs
- Electrode Tube  
0.5mm x10pcs ; 1.0 mm x10pcs
- Work Lamp  
LED:1 set
- Rubber Seal  
ER / 20 pcs
- ER Chuck  
1pcs
- X,Y Axis Linear Motor Drive
- X,Y Linear Scale
- Inverter Spindle

## OPTIONAL ACCESSORIES

- ATC/AGC
- 3.0~6.0mm Electrode
- Water Cooler
- AB Axis Indexer